

INTRODUCING FURUKAWA'S LIGHTEST, SMALLEST, AND COOLEST HEAT SINK PIPES

Japanese-engineered, *extremely lightweight and small*, and very slick, Furukawa Electric's heat pipes/coolers will make your industrial products look edgy and "cool" (no pun intended). Your customer's will love them - guaranteed. Check out Furukawa's 100W - 500W thermal solutions below.

Key Benefits:

- **Smallest** and **lightest** high power heat sink in the world.
- Lighter means **low assembly, operating**, and **freight cost**, and **less ceiling stress**.
- No MOQ means **no excess inventory**.

HYC130c

Electrical Watt Limits: 110W COB | 190W SMD (Ta=40°C)

0.8
KG

0.62
W/mK

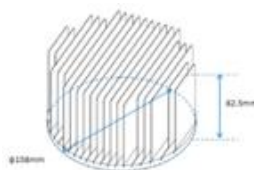
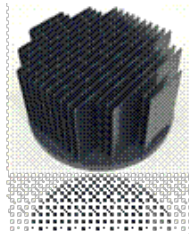

Features

- } Weight: 0.8 KG only
- } Thermal resistance: 0.62
- } COB wattage: 100W Max (Ta=40°C)
- } SMD wattage: 190W Max (Ta=40°C)
- } Φ:158mm, H= 82.5mm
- } Free customized drill holes
- } Indoor/outdoor use
- } No MOQs

Interested?

[Enquire Now](#)



[Download the HYC130c Datasheet](#)

HYC200

Electrical Watt Limits: 270W COB | 290W SMD (Ta=40°C)

1.2
KG

0.23
W/mK

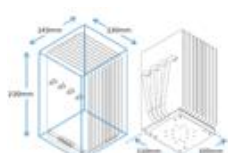
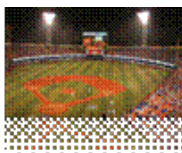
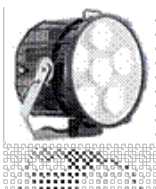

Features

- } Weight: 1.2 KG only
- } Thermal resistance: 0.23
- } COB wattage: 270W Max (Ta=40°C)
- } SMD wattage: 290W Max (Ta=40°C)
- } L: 110mm, W: 105mm, H= 220mm
- } Free customized drill holes
- } Indoor/outdoor use
- } No MOQs

Interested?

[Enquire Now](#)



[Download the HYC200 Datasheet](#)

HYC300HB

Electrical Watt Limits: 300W COB (Ta=40°C)

1
KG

0.21
W/mK

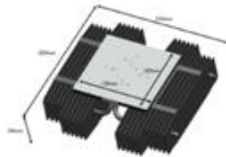
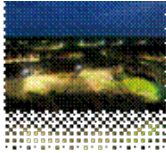
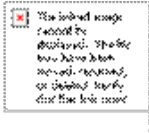
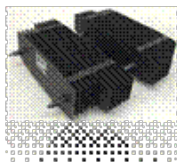

[Download the HYC300HB Datasheet](#)

Features

- } Weight: 1 KG only
- } Thermal resistance: 0.21
- } COB wattage: 320W Max (Ta=40°C)
- } L: 220mm, W:250mm, H=68mm
- } Free customized drill holes
- } Indoor/outdoor use
- } No MOQs

Interested?

[Enquire Now](#)

HYC400

Electrical Watt Limits: 400W COB (Ta=40°C)

3
KG

0.12
W/mK

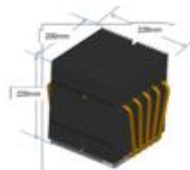
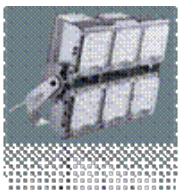

[Download the HYC400 Datasheet](#)

Features

- } Weight: 3 KG only
- } Thermal resistance: 0.12
- } COB wattage: 400W Max (Ta=40°C)
- } L: 200mm, W:226mm, H=220mm
- } Free customized drill holes
- } Indoor/outdoor use
- } No MOQs

Interested?

[Enquire Now](#)

HYC500

Electrical Watt Limits: 500W COB (Ta=40°C)

5.5
KG

0.08
W/mK

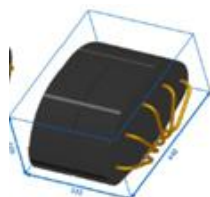
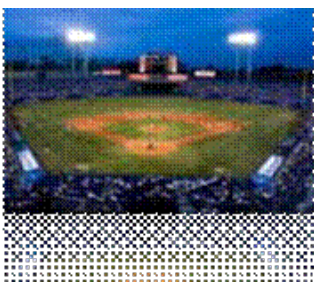

[Download the HYC500 Datasheet](#)

Features

- } Weight: 5 KG only
- } Thermal resistance: 0.08
- } COB wattage: 500W Max (Ta=40°C)
- } L: 4400mm, W:322mm, H=220mm
- } Free customized drill holes
- } Indoor/outdoor use
- } No MOQs

Interested?

[Enquire Now](#)

GET THE BUNDLE



We've simulated the perfect mix of LED lighting components to make your product come alive. For all products above, we suggest buying the **full kit** so you can plug in the sample and get started.



Interested?

Ask for the Kit

CONNECT WITH US

 RESOURCES	 CONTACT	 OUR BRANDS	
<ul style="list-style-type: none"> SCI Website SCI Line Card SCI LED Brands 	<ul style="list-style-type: none"> Sales Marketing Engineering Customer Service 	<ul style="list-style-type: none"> Bender-Wirth Citizen Inventronics LeDiL Gaggione Furukawa 	<ul style="list-style-type: none"> Carclo KHATOD VABOSS Mechatronix FrigoDynamics



[Unsubscribe](#)